

# ROLLER CONVEYORS

## RM 8320

Curve  
Powered



24V

48V

400V

### Product description

The DC roller conveyor curves change the direction of transport of conveying goods. The tapered rollers retain the alignment of the conveying goods between the side frames. A control system enables zero pressure accumulation transport. Each zone is driven by a DC RollerDrive that is connected to a fixed number of idlers via round belts.

### Scope of delivery

- Supply incl. 1 sensor per conveyor/zone
- Supply incl. bus (communication) cable
- Supply without bus (communication) cable
- Module is completely assembled and prewired
- Please order supports and end caps separately

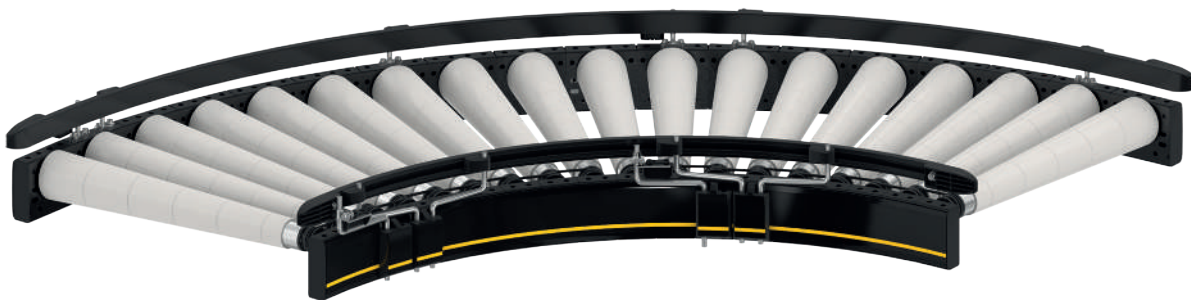

# ROLLER CONVEYORS

## RM 8320

Curve  
Powered

### Technical data

General technical data	
Max. load capacity*	50 kg/zone
Conveyor speed*	0.1 to 1.0 m/s (up to 50 kg) 1.01 to 1.39 m/s (at 35 kg, 48 V, 50 W, BI, max. 10 starts/stops per minute and minimum conveying good length of 450 mm)
Max. electrical power per zone	50 W
Incline/decline	Not suitable
Ambient temperature	0 to +40 °C normal range -30 to 0 °C deep freeze area
Roller	
Roller type	Interroll Series 1700KXO
Roller diameter	50 mm
Roller material	Steel 1.5 mm, with gray tapered polypropylene sleeves
Max. number of rollers per zone	6 for 30°, 9 for 45°, 12 for 60°, 18 for 90°
Drive	
Rated voltage	24/48 V
Motor type	Interroll RollerDrive EC5000
Drive medium	Round belt in normal range PolyVee belts in deep freeze area
Torque transmission	Roller-to-Roller
Control	MultiControl

\*The combination of maximum values is not always possible.

# ROLLER CONVEYORS

## RM 8320

Curve  
Powered



24V

48V

400V

### Dimensions

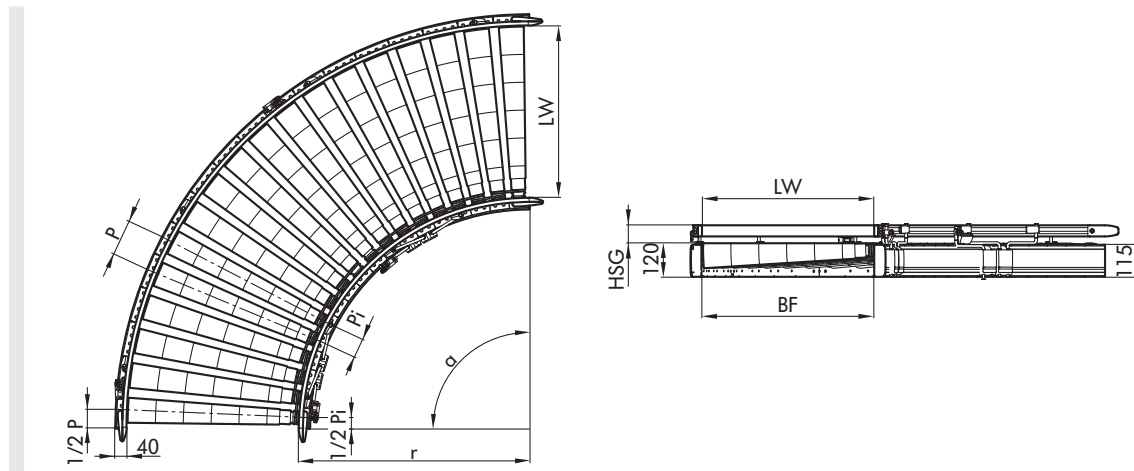

BF	Rated width	420, 620, 840 mm (others on request)
LW	Clear width	BF (+120/-90 mm per side with flexible side guide)
r	Inside radius	825 mm in normal range 791 mm in deep freeze area
$\alpha$	Bracket	30°/45°/60°/90°
TW	Module width	BF + 80 mm
Pi	Roller pitch, inside	~72 mm
P	Roller pitch, outside	~(0.087 x BF) + Pi mm
HSG	Side guide height	35 – 65 mm